

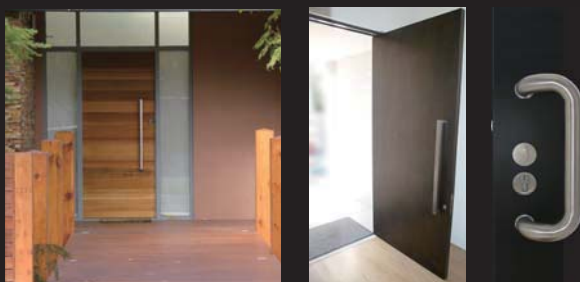

auSTYLE architectural hardware



architectural entrance handles



general accessories



heavy duty hinges / door stops



passage sets & latches



entrance handle sets & security locks



sliding door & kitchen handles



high security internal / external locks

*"Quality is never an accident,
it is the result of intention, innovation and skillful execution."*





LEVER HANDLES



- ✓ 10 Year mechanical warranty / 4 hour fire rated
- ✓ Stainless Steel "Friction Free" ball bearing mechanism for durable long term operation
- ✓ Tamper proof stainless steel fixing screws and stainless steel internal components

available in the finishes indicated below....



Satin Chrome Finish



Polished Bright Chrome Finish



PVD Anti-Tarnish Brass
(50 Year anti-tarnish warranty)

- ✓ Keren - Chrome Plate #33511
- ✓ Keren - PVD BRASS #13511



Keren - Satin Chrome - 43511



Keren - SC - 43511
with 43659 square adaptor plate

- ✓ Tanya - Chrome Plate #33512
- ✓ Tanya - PVD BRASS #13512



Tanya - Satin Chrome - 43512



Tanya - SC - 43512
with 43659 square adaptor plate

- ✓ Ilana - Chrome Plate #33514
- ✓ Ilana - PVD BRASS #13514



Ilana - Satin Chrome - 43514



Ilana - SC - 43514
with 43659 square adaptor plate

- ✓ Aliza - Chrome Plate #33515
- ✓ Aliza - PVD BRASS #13515



Aliza - Satin Chrome - 43515



Aliza - SC - 43515
with 43659 square adaptor plate

- ✓ Leah - Chrome Plate #33517
- ✓ Leah - PVD BRASS #13517



Leah - Satin Chrome - 43517



Leah - SC - 43517
with 43659 square adaptor plate

Integrated Bathroom/Privacy Kits

suits all austyle passage sets

ROUND PLATE
Satin Chrome - 49016A
Polished Chrome - 39016A
PVD Brass - 19016A



SQUARE PLATE
Satin Chrome - 49072A
Polished Chrome - 39072A
PVD Brass - 19072A





43514 Passage Set (stainless steel ball bearing mechanism) and 49031 Tubular Latch



LEVER HANDLES

10 Year mechanical warranty / 4 hour fire rated ✓
 Stainless Steel "Friction Free" ball bearing mechanism for durable long term operation ✓
 Tamper proof stainless steel fixing screws and stainless steel internal components ✓

- ✓ Daniella - Chrome Plate #33518
- ✓ Daniella - PVD BRASS #13518



Daniella - Satin Chrome - 43518



Daniella - SC - 43518
with 43659 square adaptor plate

- ✓ Talia - Chrome Plate #33520
- ✓ Talia - PVD BRASS #13520



Talia - Satin Chrome - 43520



Talia - SC - 43520
with 43659 square adaptor plate

- ✓ Daisy - Chrome Plate #33516
- ✓ Daisy - PVD BRASS #13516



Daisy - Satin Chrome - 43516



Daisy - SC - 43516
with 43659 square adaptor plate

- ✓ Raz - Chrome Plate #33519
- ✓ Raz - PVD BRASS #13519



Raz - Satin Chrome - 43519



Raz - SC - 43519
with 43659 square adaptor plate

- ✓ Naomi - Chrome Plate #33509
- ✓ Naomi - PVD BRASS #13509



Naomi - Satin Chrome - 43509



Naomi - SC - 43509
with 43659 square adaptor plate



RENOVATING?
 -Don't change doors -
 use our plates with any
 austyle locks & passage sets
 No Patching!
 No Painting!

43566 (without cylinder hole)
 43566E (cylinder hole @ 85mm) [refer p12 locks]
 Adaptor/Multi Cover plates; 230x65mm
 "slip over" austyle passage sets.



Backing cover plates sit behind back plate
ROUND 49816 SC **SQUARE** 49818 SC
 ROUND CP 39816
 ROUND PVD Brass 19816



Accessories & Adaptor Plates

9821
 Generic Spindle & Screw Kit
 2 x Sprung spindles }
 2 x Tie Bolt fixing screws }
 (1 set with concealed head)



9822
 Dummy Fixing Spindle

316 S/Steel Lever Handles

It may look the same on the outside but whats on the inside really matters.

316 STAINLESS STEEL HANDLES
ANYTHING ELSE IS A COMPROMISE!

- 10 Year mechanical warranty / 4 hour fire rated
- Stainless Steel "Friction Free" ball bearing mechanism for durable long term operation
- Tamper proof stainless steel fixing screws and stainless steel internal components
- Reversible levers for either left or right hand opening doors



43689 Aaron 316 Stainless Steel Lever Set (below)
49201 Stainless Steel 30mm Narrow Style Entrance Lock
49144 Double Cylinder

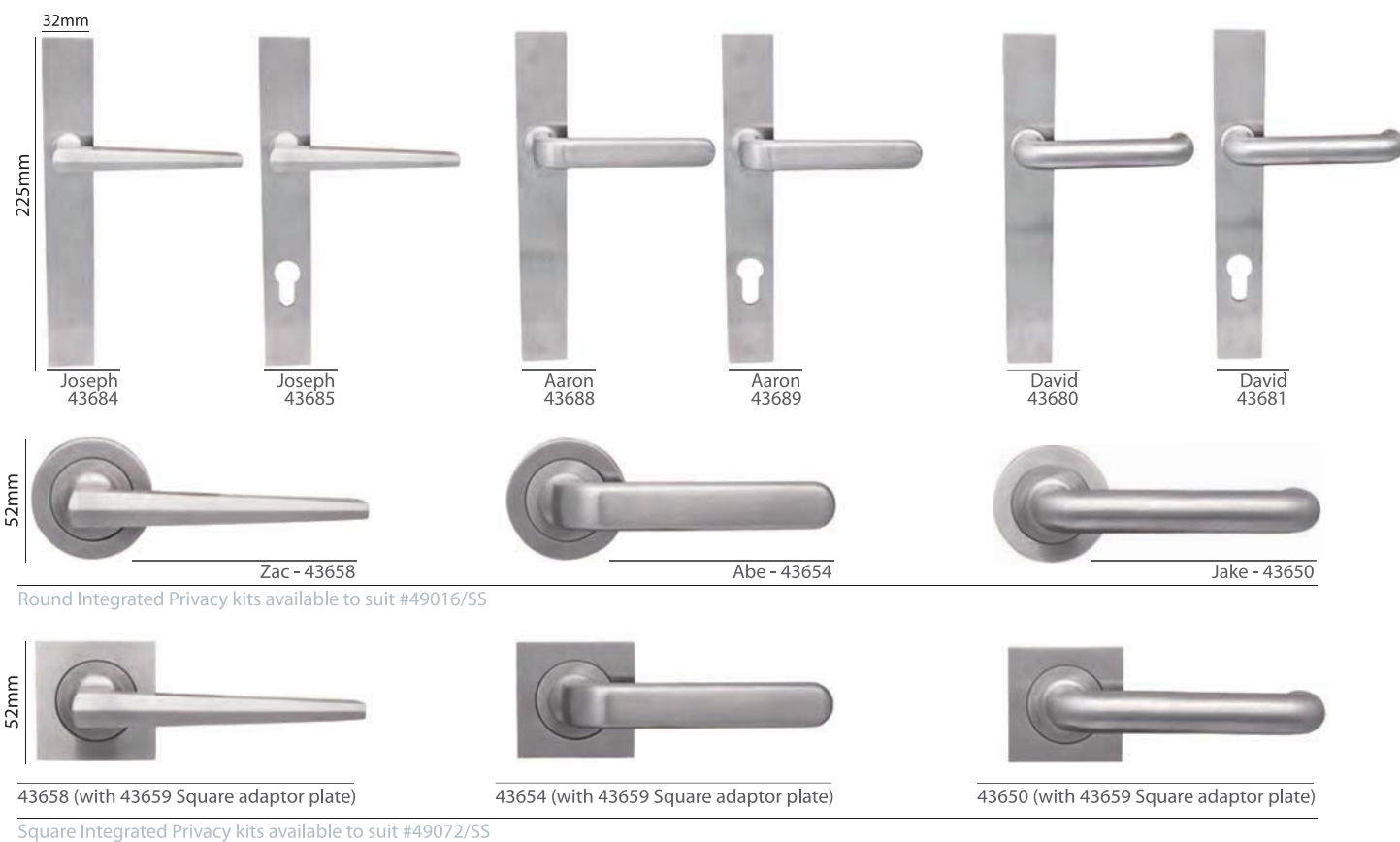

Minimal Range

- Designed with a neat 42mm backplate for a "clean minimal" modern appearance
- 10 Year mechanical warranty / 4 hour fire rated
- Stainless Steel "Friction Free" ball bearing mechanism for durable long term operation



myLOCK

The all in one, **integrated** latch/privacy/dead bolt entrance lock

Entrance Levers

- ✓ Satin Chrome Finish (Solid Brass Material) with Stainless Steel Ball Bearing Mechanism
- ✓ External Side has a concealed design appearance and which enables tamper proof fixing advantage.
- ✓ Internal Side includes privacy snib which is pre-assembled for easy installation



Entrance Lock

- ✓ myLOCK integrated latch, privacy and dead bolt [to SUIT ENTRANCE LEVERS ABOVE]
- ✓ For front door applications, this new lock has a quick lock/release privacy function for "Keyless Locking"
- ✓ When using the handle to exit, the privacy mechanism also automatically unlocks the door for a quick easy exit – without the need for keys!
- ✓ Furthermore, the lock has full keyed dead bolt functionality as required for insurance purposes for the ultimate level of security.

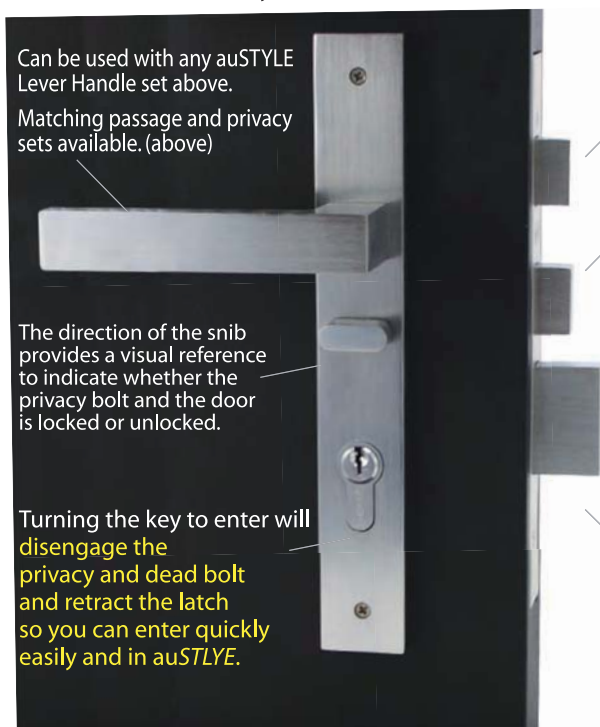

Heavy Duty Latch Mechanism for reliable entry and exit. Reversible for either Left or Right hand opening doors.

Keyless locking is available by using the snib when home to prevent anyone opening the door and walking in. **Its a quick and simple locking function for every day use and works independently of the dead bolt.**

Engage the dead bolt for the ultimate level of security when you're out of the house or away on holiday.

The bolt is made from solid brass (40x10mm thick!) and extends 85mm across the door jamb and back into the case providing security and piece of mind.



Satin Chrome - 49219

Interchangeable Face & Striker plates:
Chrome Plate - 39219
Antique Copper - 29219
Polished Brass - 9219

Rebate Kit to suit
Satin Chrome - 49220

**New Commercial Range
for narrow door styles
- Perfect for security gates -**

Narrow Style Entrance Sets

- ✓ Designed for all timber or aluminium door styles
- ✓ Heavy duty ball bearing mechanism and components
(ideal for commercial applications requiring extended durability)
- ✓ Tie Bolt thru fixing (cylinders/locks sold separately ref p 11/12/13)



43611E - Stainless Steel Ball Bearing Mechanism Lever Set
49201 - Stainless Steel 30mm Narrow Style Entrance Lock
49144 - Double Cylinder

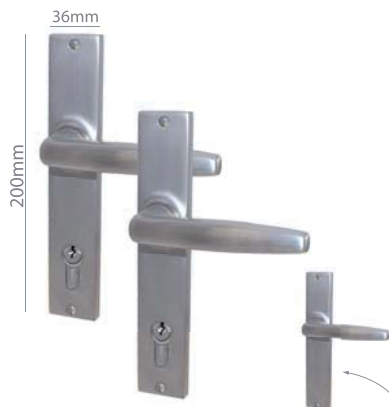

Entrance Set suits 85mm cylinder lock - 43610E
Passage Set (no cylinder hole) - 43610
[Also available: matching lever with 52mm round rose backplate refer p2-3]



Entrance Set suits 85mm cylinder lock - 43611E
Passage Set (no cylinder hole) - 43611
[Also available: matching lever with 52mm round rose backplate refer p2-3]



Entrance Set suits 85mm cylinder lock - 43624E



Entrance Set suits 85mm cylinder lock - 43614E
Passage Set (no cylinder hole) - 43614
[Also available: matching lever with 52mm round rose backplate refer p2-3]



Entrance Set suits 85mm cylinder lock - 43618E
Passage Set (no cylinder hole) - 43618
[Also available: matching lever with 52mm round rose backplate refer p2-3]



Entrance Set suits 85mm cylinder lock - 43620E

Passage Sets

- ✓ 10 Year mechanical warranty / 4 hour fire rated
- ✓ Stainless Steel "Friction Free" ball bearing mechanism for durable long term operation
- ✓ Tamper proof stainless steel fixing screws and heavy duty internal components



Sarah - Satin Chrome - 43600
Sarah - Polished Chrome - 33600



Dafna - Polished Chrome - 33604



Orli - Satin Chrome - 43605
Orli - Polished Chrome - 33605



Eden - Satin Chrome - 43603
Eden - Polished Chrome - 33603

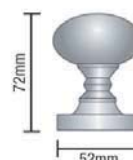

Sarah - Satin Chrome - 43510
Sarah - Polished Chrome - 33510
Sarah - PVD Brass - 13510

Feature Door Entrance Handles

- ✓ Create a modern entrance with designer security
- ✓ High security roller lock with integrated privacy & dead bolt
- ✓ Matching snib / escutcheons sets to suit entrance handle styles

Heavy Duty Roller Latch Mechanism. There is an ADJUSTABLE SPRING TENSION in the roller to suit your desired opening tension.

Unlocking the dead bolt cylinder will also simultaneously unlock and release the privacy function for a quick exit.



The direction of the SNIB PROVIDES A VISUAL REFERENCE to indicate whether the privacy bolt (and the door) is in the locked or unlocked position.



49217 Satin Chrome

Alternative Face & Striker plates:
Chrome Plate - 39217
Antique Copper - 29217
Polished Brass - 9217



Integrated Round Snib/Escutcheon
43737



Integrated Square Snib/Escutcheon
43736

Handle Design
43836 (450mm)

Handle Design
43888 (500mm)



Polished Stainless Steel Finish

item#	details	L	C	D	P
33885	1pc Single	300	285	25x50mm	50
33886	2pcs Back-to-back	300	285	25x50mm	50
33887	1pc Single	500	475	25x50mm	50
33888	2pcs Back-to-back	500	475	25x50mm	50

Satin Stainless Steel Finish

item#	details	L	C	D	P
43885	1pc Single	300	285	25x50mm	50
43886	2pcs Back-to-back	300	285	25x50mm	50
43887	1pc Single	500	475	25x50mm	50
43888	2pcs Back-to-back	500	475	25x50mm	50
43889	1pc Single	800	757	25x50mm	50
43890	2pcs Back-to-back	800	757	25x50mm	50

Key to handle specifications

L = Overall Length of the handle
C = Screw Fixing centre-to-centre
D = Diameter of handle
P = Overall Projection

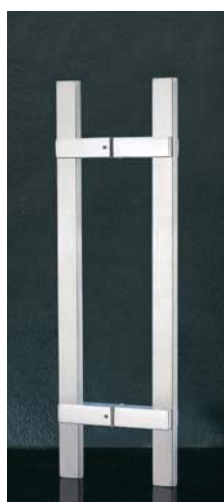
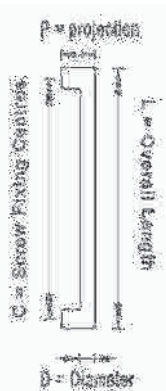

Satin Stainless Steel Finish

item#	details	L	C	D	P
43815	1pc Single	300	250	20x10mm	55mm
43816	2pcs Back-to-back	300	250	20x10mm	55mm
43817	1pc Single	600	400	30x15mm	82mm
43818	2pcs Back-to-back	600	400	30x15mm	82mm
43819	1pc Single	900	700	30x15mm	82mm
43820	2pcs Back-to-back	900	700	30x15mm	82mm



Satin Stainless Steel Finish

item#	details	L	C	D	P
43823	1pc Single	400	370	30x15mm	67
43824	2pcs Back-to-back	400	370	30x15mm	67
43827	1pc Single	800	770	40x15mm	67
43828	2pcs Back-to-back	800	770	40x15mm	67

Feature Door Entrance Handles



- ✔ Create a modern entrance with designer security
- ✔ High security roller lock with integrated privacy & dead bolt
- ✔ Matching snib / escutcheons sets to suit entrance handle styles

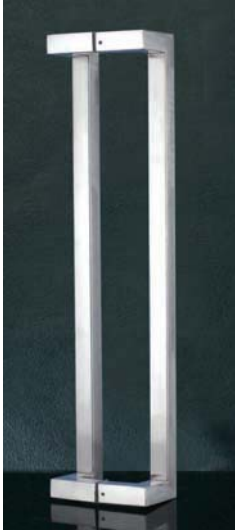

Polished Bright Stainless Steel Finish

item#	details	L	C	D	P
33829	1pc Single	600	575	25x25mm	67
33830	2pcs Back-to-back	600	575	25x25mm	67



Satin Stainless Steel Finish

item#	details	L	C	D	P
43807	1pc Single	450	300	25x25mm	65
43808	2pcs Back-to-back	450	300	25x25mm	65
43809	1pc Single	600	400	25x25mm	65
43810	2pcs Back-to-back	600	400	25x25mm	65
43811	1pc Single	900	600	25x35mm	75
43812	2pcs Back-to-back	900	600	25x35mm	75
43813	1pc Single	1200	900	25x35mm	75
43814	2pcs Back-to-back	1200	900	25x35mm	75



Entry Handle 800mm 43890
Square Snib Kit 43736
Double Cylinder 65mm 49144
Integrated Privacy/Dead Lock 49217

Satin Stainless Steel Finish

item#	details	L	C	D	P
43829	1pc Single	600	575	25x25mm	67
43830	2pcs Back-to-back	600	575	25x25mm	67

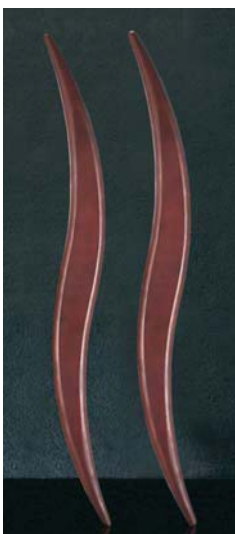

Solid Oak

item#	details	L	C	D	P
43861	1pc Single	800	400	60	75
43862	2pcs Back-to-back	800	400	60	75



Satin Stainless Steel Finish

item#	details	L	C	D	P
43901	1pc Single	600	400	45	72
43902	2pcs Back-to-back	600	400	45	72
43905	1pc Single	1200	900	45	72
43906	2pcs Back-to-back	1200	900	45	72

- ✓ Create a modern entrance with designer security
- ✓ High security roller lock with integrated privacy & dead bolt
- ✓ Matching snib / escutcheons sets to suit entrance handle styles



Satin Stainless Steel Finish

item#	details	L	C	D	P
43863	1pc Single	600	400	38	80
43864	2pcs Back-to-back	600	400	38	80



Satin Stainless Steel Finish

item#	details	L	C	D	P
43865	1pc Single	450	300	25	70
43866	2pcs Back-to-back	450	300	25	70
43867	1pc Single	600	400	32	77
43868	2pcs Back-to-back	600	400	32	77



Satin Stainless Steel Finish

item#	details	L	C	D	P
43845	1pc Single	450	300	32	71
43846	2pcs Back-to-back	450	300	32	71
43847	1pc Single	600	400	38	77
43848	2pcs Back-to-back	600	400	38	77
43849	1pc Single	900	600	38	77
43850	2pcs Back-to-back	900	600	38	77
43851	1pc Single	1200	900	38	77
43852	2pcs Back-to-back	1200	900	38	77



Satin Stainless Steel Finish

item#	details	L	C	D	P
43869	1pc Single	300	200	25	60
43870	2pcs Back-to-back	300	200	25	60
43873	1pc Single	600	400	32	90
43874	2pcs Back-to-back	600	400	32	90
43875	1pc Single	900	600	38	90
43876	2pcs Back-to-back	900	600	38	90



- ✓ Create a modern entrance with designer security
- ✓ High security roller lock with integrated privacy & dead bolt
- ✓ Matching snib / escutcheons sets to suit entrance handle styles



Dark Walnut Centre - Polished Stainless Steel Ends

item#	details	L	C	D	P
43857	1pc Single	800	550	38 _{mm}	75
43858	2pcs Back-to-back	800	550	38 _{mm}	75



Oak Centre Polished Ends

item#	details	L	C	D	P	details	item#
43909	1pc Single	600	575	45	63	1pc Single	43915
43910	2pcs Back-to-back	600	575	45	63	2pcs Back-to-back	43916



Satin Centre/Polished Ends



Satin Stainless Steel Finish

item#	details	L	C	D	P
43831	1pc Single	450	425	25 _{mm}	64
43832	2pcs Back-to-back	450	425	25 _{mm}	64
43833	1pc Single	300	268	32 _{mm}	81
43834	2pcs Back-to-back	300	268	32 _{mm}	81
43835	1pc Single	450	418	32 _{mm}	81
43836	2pcs Back-to-back	450	418	32 _{mm}	81
43841	1pc Single	600	568	32 _{mm}	81
43842	2pcs Back-to-back	600	568	32 _{mm}	81
43843	1pc Single	1300	1268	32 _{mm}	81
43844	2pcs Back-to-back	1300	1268	32 _{mm}	81



Satin Stainless Steel Finish

item#	details	L	C	D	P
43891	1pc Single	400	280	38 _{mm}	74
43892	2pcs Back-to-back	400	280	38 _{mm}	74
43893	1pc Single	600	400	38 _{mm}	74
43894	2pcs Back-to-back	600	400	38 _{mm}	74
43895	1pc Single	900	700	45 _{mm}	82
43896	2pcs Back-to-back	900	700	45 _{mm}	82
43897	1pc Single	1800	1500	45 _{mm}	82
43898	2pcs Back-to-back	1800	1500	45 _{mm}	82

Satin Stainless Steel Finish

item#	details	L	C	D	P
43881	1pc Single	350	325	25 _{mm}	67
43882	2pcs Back-to-back	350	325	25 _{mm}	67
43883	1pc Single	600	562	38 _{mm}	88
43884	2pcs Back-to-back	600	562	38 _{mm}	88



304 Stainless Steel

SECURITY

- ✓ Designed and Engineered in Australia
- ✓ 304 Stainless Steel heavy duty case and internal mechanical components.
- ✓ Non combustable components

Hinged Doors

Narrow Style
self latching snib latch for **HINGED** doors
aluminium (or timber) applications



high security entrance lock with
emergency release/ESCAPE function

all internal/external commercial/residential
(or fire door) applications



Sliding Doors

ideal for narrow door styles
self latching snib latch for **SLIDING** Doors
residential or commercial applications



self latching snib latch for **HINGED** Doors
residential or commercial applications

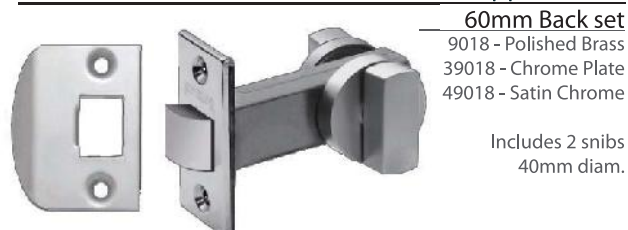

passage **LATCH** suitable for commercial
or residential applications



extended stainless steel striker plates



entrance locks for internal or external &
commercial or residential applications

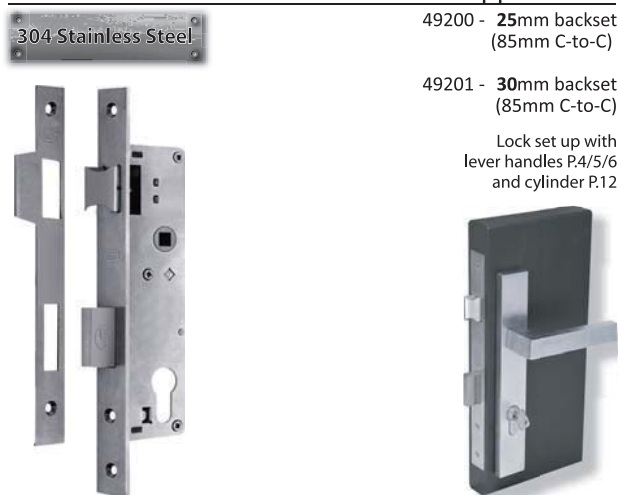

roller locks for internal or external & commercial
or residential applications



SECURITY

Hinged Doors

- ✓ Designed and Engineered in Australia
- ✓ Heavy Duty steel casing and solid full length dead bolt
- ✓ Non combustable components



High Security Entrance Dead Lock (47.6mm Centres)

- ✓ Simultaneously retracts latch when unlocking the door for a quick exit
- ✓ Hardened steel rolling pins in bolt resist hacksawing - 24mm throw!
- ✓ Reversible latch for either LH / RH opening doors

45mm Back set

9000 - Polished Brass
29000 - Antique Copper
39000 - Chrome Plate
49000 - Satin Chrome

60mm Back set

9001 - Polished Brass
29001 - Antique Copper
39001 - Chrome Plate
49001 - Satin Chrome



Rebated Lock 45mm Back set

9002 - Polished Brass
29002 - Antique Copper
39002 - Chrome Plate
49002 - Satin Chrome

Rebated Lock 60mm Back set

9003 - Polished Brass
29003 - Antique Copper
39003 - Chrome Plate
49003 - Satin Chrome

Separate Rebate Kit only (without lock)

9004 - Polished Brass
29004 - Antique Copper
39004 - Chrome Plate
49004 - Satin Chrome



High Security Entrance Dead Lock (85mm centres)

- ✓ Simultaneously retracts latch when unlocking the door for a quick exit
- ✓ Reversible latch for either LH / RH opening doors

45mm Back set

9208 - Polished Brass
39208 - Chrome Plate
49208 - Satin Chrome

60mm Back set

9209 - Polished Brass
39209 - Chrome Plate
49209 - Satin Chrome

Separate Rebate Kit only (without lock)

9210 - Polished Brass
39210 - Chrome Plate
49210 - Satin Chrome



Cylinder Barrels to suit euro locks

- ✓ C4 euro profile
- ✓ Available keyed alike
- ✓ Approved for master keying
- ✓ S/Steel internal springs for durability and reliability

5Pin euro single cylinder 39mm

9142-PB
29142-ATQ
39142-CP
49142-SC

5Pin euro double cylinder - 60mm

9143-PB
29143-ATQ
39143-CP
49143-SC

5Pin euro double cylinder - 65mm

*9144-PB
19144-PVD
*29144-ATQ
*39144-CP
*49144-SC

"Now with independent cam operation so you can use a key simultaneously on both sides!"

6Pin euro double cylinder - 70mm

9147-PB
39147-CP
*49147-SC

"Now with independent cam operation so you can use a key simultaneously on both sides!"

6Pin euro double cylinder - 80mm

9148-PB
39148-CP
*49148-SC

"Now with independent cam operation so you can use a key simultaneously on both sides!"

Turn Snib cylinder - 39mm

9141-PB
39141-CP
49141-SC

5Pin Single/Turn Snib cylinder - 65mm

9145-PB
29145-ATQ
39145-CP
49145-SC

6Pin Single/Turn Snib cylinder - 70mm

49149-SC



**Make an informed decision about the locks you choose;
Compare our features and don't settle for anything less.
- We've nothing to hide & you've everything to gain!**

High Security Entrance Lock (47.6mm Centres - above)

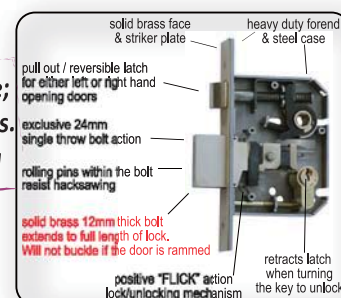

SECURITY

- ✓ Designed and Engineered in Australia
- ✓ Heavy Duty steel casing and solid componentry
- ✓ Non combustable components

Sliding Doors



High Security Sliding Door Dead Lock

Heavy duty steel backing plate for additional strength and security

New: elongated striker plate holes to allow for movement in the door

2 x Locating Pins guide the door into correct position when closing

45mm Back set - (Cylinder/escutcheon sold separately)



Euro Cylinder Lock

9086 - Polished Brass

29086 - Antique Copper

39086 - Chrome Plate

49086 - Satin Chrome

5 Lever Lock^(skeleton Key)

9084 - Polished Brass

29084 - Antique Copper

39084 - Chrome Plate

49084 - Satin Chrome

High Security External Doors:

Use any keyed cylinders (p12)
and escutcheons (p16)

Bathroom door applications?

Use a privacy snib
cylinder which has an
emergency release function
(ref:bottom p14)

Hinged Doors

High Security Roller Latch And Dead Bolt

Adjustable spring tension / both LH / RH striker plate supplied / used in conjunction with entry handles and escutcheons



45mm Back set

49206 - Satin Chrome

60mm Back set

49207 - Satin Chrome

Rebate Kit (without lock)

49210 - Satin Chrome



53mm Back set

19015 - PVD Brass

29015 - Antique Copper

39015 - Chrome Plate

49015 - Satin Chrome

Rebated Roller Lock

39005 - Chrome Plate

49005 - Satin Chrome

49015 High Security Roller Dead Lock
with 49143 Double Turn Cylinder / 43724 Escutcheon

High security Dead Bolt

Heavy duty steel backing plate for additional strength and security

60mm Back set - (49143 cylinder / 43702 escutcheon sold separately)

Suitable for either LH / RH opening doors



Euro Cylinder Lock

9012 - Polished Brass

29012 - Antique Copper

39012 - Chrome Plate

49012 - Satin Chrome

49012 High Security Dead Bolt with
49146 Privacy Cylinder / 43726 Escutcheon

SECURITY

Passage Latches



49019 Stainless Steel Latch (below) / 43514 Ilana Lever (P2)

Tubular Latch - Heavy Duty

Stainless Steel Spring / Solid Brass Follower

60mm Backset

Double Spring

9030 - PB
29030 - ATQ
39030 - CP
49030 - SC

Single Spring

9031 - PB
29031 - ATQ
39031 - CP
49031 - SC



60mm Backset - Rebate Doors

Single Spring

9029 - PB
29029 - ATQ
39029 - CP
49029 - SC



Stainless Steel

304 Stainless Steel material with split follower - 60mm Backset

Single Spring

19019 - PVD Brass
39019 - Polished S/Steel
49019 - Satin S/Steel



45mm Backset

Single Spring

9028 - PB
29028 - ATQ
39028 - CP
49028 - SC



60mm Backset - Light Duty

Single Spring - Split Follower

9017 - PB
39017 - CP
49017 - SC



Roller Catch

Adjustable Roller Tension

9026 - PB
39026 - CP
49026 - SC



BATHROOM PRIVACY

Sliding Doors



Cavity / Recessed Sliding Doors

Latching (only)

9049 - PB
29049 - ATQ
39049 - CP
49049 - SC

Locking

9050 - PB
29050 - ATQ
39050 - CP
49050 - SC

Ideal for all cavity sliding doors

Tubular bolt with locating pin which guides the door into its correct position when closing - (50mm overall / 31mm to spindle centre)

19033 - PVD
29033 - ATQ
39033 - CP
49033 - SC



(see suitable snib options on page 15)

Hinged Doors

Indicator Bolt - Heavy Duty

9014 - PB
39014 - CP
49014 - SC



Snib & Release Euro Cylinder

Used with all mortice locks (p12/13)

9146 - PB / 39146 - CP / 49146 - SC



With
Emergency
Release Slot



49146 Snib & Release Cylinder
49001 Cylinder Lock (p12)
43726 Square Escutcheon

Tubular Bolt - Heavy Duty

60mm Backset

9032 - PB 29032 - ATQ
39032 - CP 49032 - SC



(see suitable snib options on page 15)



49032 Tubular Bolt
49038 Bathroom Snib and Release (P15)
43514 Ilana lever (P2) / 49031 latch (above)

Accessories

Flush Pulls

304 Stainless Steel Flush Pulls

ideal for all bi-fold / sliding or cavity doors
black powder coating available



43740
120x40x12mm



33744 Polished SS
43744 Satin SS
120x40x12mm



43739
120x40x12mm



Create a modern architectural appearance
with our new larger 220 or 320mm rectangle designs

33745 - 100x50mm (Polished SS)

Recess Depth 10mm

43745 - 100x50mm (Satin SS)

43749 - 150x50mm

43752 - 220x55mm

43753 - 320x55mm



43746
diam. 76x14mm
Flush Ring with
Operable Latching Function
Used with bolts/latches P14



43743
diam.90mm x12mm



43741
(see pic previous page) 65mm



43742
70x70x14mm



43750 - 70x70x12mm
43751 - 50x50x12mm



33747 - Polished SSteel
43747 - Satin SSteel
45x62x7mm

BATHROOM PRIVACY

Snib Styles

Snib/Emergency release styles and options to accompany either the sliding or hinged tubular bolts on P14.

Ideal for **SLIDING doors** that recess all the way back into a cavity
These snibs are recessed into the door and sit flush on the door face
Concealed fixing for a clean modern appearance (Refer pic P14). Diameter 40mm.

9040 - PB
39040 - CP
49040 - SC



49033 Sliding Door Lock (P14)
49040 Flush Snib and Release
43741 Round Flush Pull (above)

Ideal for Hinged doors

43x25mm Rectangle

35mm diameter

9034 - PB
29034 - ATQ
39034 - CP
49034 - SC



9035 - PB
29035 - ATQ
39035 - CP
49035 - SC



Ideal for **HINGED or SLIDING** that sit slightly proud of the cavity
These snibs have concealed fixing for a modern clean appearance

SIZES: 35x35mm square / 35mm diameter round

9046- PB
39046 - CP
49046 - SC



19038 - PVD Brass
29038 - ATQ
39038 - CP
49038 - SC

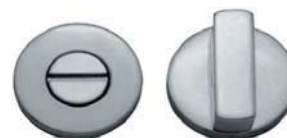

9037 - PB
39037 - CP
49037 - SC

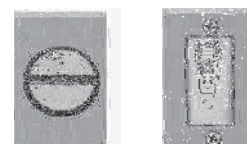

SECURITY

Escutcheons

Escutcheon cover plates

*Cylinders sold separately - Refer P12



43724 Stainless Steel Escutcheon (below)
49086 Sliding Door Lock
49145 Turn Cylinder

Square Range / Euro Cylinder Profile



40x40mm Square (8mm projection)
[cylinder sold separately]

33726 - CP
43726 - SC



304 Stainless Steel (10mm projection)
[cylinder sold separately]

Rectangular 70x30mm

13724 - PVD (Brass)
33724 - Polished SS
43724 - Satin SS



Oval 70x30mm

13725 - PVD (Brass)
33725 - Polished SS
43725 - Satin SS

Round/Euro Cylinder Profile



52mm Square edged (8mm projection)

13702 - PVD (Brass)
23702 - ATQ
33702 - CP
43702 - SC



Square edged (8mm projection)

45mm

13701 - PVD (Brass)
33701 - CP
43701 - SC

40mm

13700 - PVD (Brass)
33700 - CP
43700 - SC



52mm Rounded edge (8mm projection)

13703 - PVD (Brass)
33703 - CP
43703 - SC



304 Stainless Steel

52mm Square edged (8mm projection)
43704 - Satin Stainless Steel

Round / Oval Cylinder Profile



52mm Square edged (8mm projection)

13707 - PVD (Brass)
33707 - CP
43707 - SC



Square edged (8mm projection)

45mm

13706 - PVD (Brass)
33706 - CP
43706 - SC

40mm

13705 - PVD (Brass)
33705 - CP
43705 - SC



52mm Rounded edge (8mm projection)

13708 - PVD (Brass)
33708 - CP
43708 - SC



Blank Concealing Escutcheon

52mm Square edged (8mm projection)
33709 - CP
43709 - SC

General Accessories



Extended Striker Plate

Reversible for either LH/RH openings
Stainless Steel
49840 - 85mm (60mm extension lip)
49841 - 125mm (100mm extension lip)



Extended Striker Plate

Stainless Steel
49839 - 100x25mm

Round Snib Set

32mm Diameter
9044 - PB
39044 - CP
49044 - SC



Square Snib Set

40x40mm
49045 - SC





43516
316 Marine Grade S/Steel

It may look the same on the outside but whats on the inside really matters.
316 STAINLESS STEEL HINGES
ANYTHING ELSE IS A COMPROMISE!

316 Marine Grade Stainless Steel

Satin Stainless Steel Finish			
43516	Fixed Pin	100x75x2.5mm	
43518	Loose Pin	100x75x2.5mm	
43517	Fixed Pin	100x100x2.5mm	



304 High Grade Stainless Steel

Satin Stainless Steel Finish			
45112	Fixed Pin	100x125x3.5mm	
45111	Fixed Pin	100x150x3.5mm	
45110	Fixed Pin	100x175x3.5mm	
45113	Fixed Pin	100x200x3.5mm	



Polished Stainless Steel Finish			
NEW (2013)	35111	Fixed Pin	100x150x3.5mm
	35110	Fixed Pin	100x175x3.5mm

304 S/Steel material PVD Anti-Tarnish (Brass Finish)			
NEW	15111	Fixed Pin	100x150x3.5mm
	15110	Fixed Pin	100x175x3.5mm



HINGES

- ✓ All hinges include S/Steel phillips head wood screws
- ✓ M5/12mm Metal Thread screws available #9900

304 High Grade Stainless Steel

Fixed Pin / Satin Stainless Steel Finish		
45105	85x60x2mm	
45107	100x60x2.5mm	
45108	100x75x2.5mm	
45109	100x100x2.5mm	



Loose Pin / Satin Stainless Steel Finish		
45115	85x60x2mm	
45118	100x75x2.5mm	

Fixed Pin / Polished Stainless Steel Finish		
35108	100x75x2.5mm	
35109	100x100x2.5mm	

Loose Pin / Polished Stainless Steel Finish		
35115	85x60x2mm	
35118	100x75x2.5mm	

304 High Grade Stainless Steel with PVD Brass ANTI-TARNISH finish

Fixed Pin		
15108	100x75x2.5mm	
15109	100x100x2.5mm	

Loose Pin		
15117	100x60x2mm	
15118	100x75x2.5mm	



Self Closing

304 High Grade Stainless Steel

Satin Stainless Steel Finish			
45134	Left Hand	100x75x2.5mm	
45135	Right Hand	100x75x2.5mm	

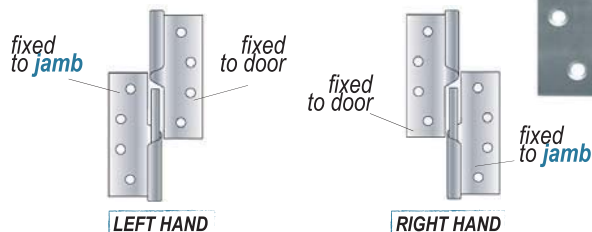

Lift Off (for toilet doors)

304 High Grade Stainless Steel

Satin Stainless Steel Finish			
45130	Left Hand	89x60x2mm	
45131	Right Hand	89x60x2mm	
45132	Left Hand	100x75x2.5mm	
45133	Right Hand	100x75x2.5mm	



12mm pin extension - (Lift off distance)

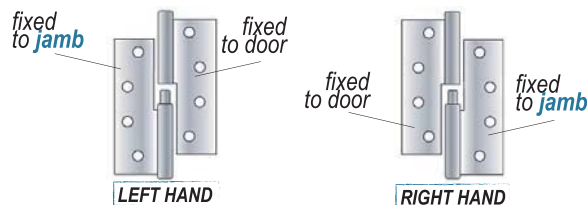

Fast Fix / Hirline Bearing Hinges

304 High Grade Stainless Steel

NEW	45143	Satin S/Steel	89x35x2mm
	45144	Satin S/Steel	100x47x2.5mm
	45142	Satin S/Steel	76x30x1.5mm
	15144	PVD Brass	100x47x2.5mm



304 S/Steel Handles

- ✓ High Grade 304 Solid Stainless Steel
- ✓ Minimal 7.8% Nickle content (durability & corrosion resistance)
- ✓ Includes 2 x40mm M4 screws with snap off points
- ✓ Brushed S/Steel finish



48730 Stainless Steel Kitchen Handle 12mm (below)

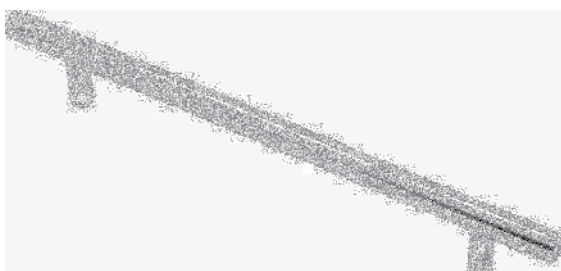

✓ 10mm Diameter

Item Code	Overall Length	Centre-to- Centre	Diameter	Projection
48718	146mm	96mm	10mm	30mm
48719	196mm	146mm	10mm	30mm
48720	210mm	160mm	10mm	30mm
48721	250mm	200mm	10mm	30mm
48722	300mm	250mm	10mm	30mm
48723	350mm	300mm	10mm	30mm
48724	400mm	350mm	10mm	30mm
48725	450mm	400mm	10mm	30mm

✓ 12mm Diameter

Item Code	Overall Length	Centre-to- Centre	Diameter	Projection
48728	146mm	96mm	12mm	30mm
48729	196mm	146mm	12mm	30mm
48730	210mm	160mm	12mm	30mm
48731	250mm	200mm	12mm	30mm
48732	300mm	250mm	12mm	30mm
48733	350mm	300mm	12mm	30mm
48734	400mm	350mm	12mm	30mm
48735	450mm	400mm	12mm	30mm
48736	550mm	500mm	12mm	30mm
48737	650mm	600mm	12mm	30mm

✓ 8x8mm Square

Item Code	Overall Length	Centre-to- Centre	Diameter	Projection
48690	113mm	63mm	8x8mm	38mm
48691	146mm	96mm	8x8mm	38mm
48692	196mm	146mm	8x8mm	38mm
48693	260mm	210mm	8x8mm	38mm
48694	356mm	306mm	8x8mm	38mm
48695	452mm	402mm	8x8mm	38mm
48696	500mm	450mm	8x8mm	38mm

✓ 12x12mm Square

Item Code	Overall Length	Centre-to- Centre	Diameter	Projection
48708	113mm	63mm	12x12mm	40mm
48709	146mm	96mm	12x12mm	40mm
48710	196mm	156mm	12x12mm	40mm
48711	260mm	210mm	12x12mm	40mm
48712	356mm	306mm	12x12mm	40mm
48714	452mm	402mm	12x12mm	40mm
48716	550mm	500mm	12x12mm	40mm
48717	650mm	600mm	12x12mm	40mm



43741 200mm
Streamline 304 Stainless Steel Handle

304 S/Steel Handles

- ✓ High Grade 304 Stainless Steel
- ✓ Minimal 7.8% Nickle content for strength, durability and corrosion resistance
- ✓ Includes 2 x40mm M4 screws with snap off points
- ✓ Brushed S/Steel finish



Item Code	Overall Length	Centre-to-Centre	Diameter	Projection
48738	83mm	75mm	15x15mm	30mm
48739	108mm	100mm	15x15mm	30mm
48740	158mm	150mm	15x15mm	30mm
48741	208mm	200mm	15x15mm	30mm
48742	308mm	300mm	15x15mm	30mm
48743	408mm	400mm	15x15mm	30mm
48744	508mm	500mm	15x15mm	30mm
48745	608mm	600mm	15x15mm	30mm



Item Code	Overall Length	Centre-to-Centre	Diameter	Projection
48698	87mm	75mm	12x12mm	30mm
48699	120mm	108mm	12x12mm	30mm
48700	170mm	158mm	12x12mm	30mm
48701	212mm	200mm	12x12mm	30mm
48702	312mm	300mm	12x12mm	30mm
48703	412mm	400mm	12x12mm	30mm
48704	512mm	500mm	12x12mm	30mm
48705	612mm	600mm	12x12mm	30mm
48706	812mm	800mm	12x12mm	30mm



Item Code	Overall Length	Centre-to-Centre	Diameter	Projection
48775	83mm	75mm	10x20mm	30mm
48776	108mm	100mm	10x20mm	30mm
48777	158mm	150mm	10x20mm	30mm
48778	208mm	200mm	10x20mm	30mm
48779	308mm	300mm	10x20mm	30mm
48780	408mm	400mm	10x20mm	30mm
48781	508mm	500mm	10x20mm	30mm
48782	608mm	600mm	10x20mm	30mm



Item Code	Overall Length	Centre-to-Centre	Diameter	Projection
48784	115mm	55mm	10x20mm	30mm
48785	160mm	100mm	10x20mm	30mm
48786	210mm	150mm	10x20mm	30mm
48787	260mm	200mm	10x20mm	30mm
48788	360mm	300mm	10x20mm	30mm
48789	460mm	400mm	10x20mm	30mm
48790	560mm	500mm	10x20mm	30mm
48791	660mm	600mm	10x20mm	30mm
48792	860mm	700mm	10x20mm	30mm

304 S/Steel Handles

- ✓ High Grade 304 Solid Stainless Steel
- ✓ Minimal 7.8% Nickle content =Strength, Durability and corrosion resistance
- ✓ Includes 2 x40mm M4 screws with snap off points
- ✓ Brushed S/Steel finish



48728 Stainless Steel Kitchen Handle
(P16)

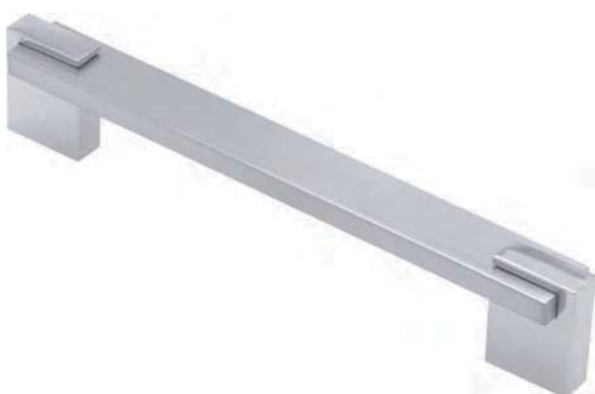

✓ 10mm Diameter

Item Code	Overall Length	Centre-to- Centre	Diameter	Projection
48750	83mm	74mm	10mm	32mm
48751	107mm	98mm	10mm	32mm
48752	147mm	138mm	10mm	32mm
48753	180mm	171mm	10mm	32mm

✓ 12mm Diameter

Item Code	Overall Length	Centre-to- Centre	Diameter	Projection
48754	107mm	98mm	12mm	32mm
48755	137mm	126mm	12mm	32mm
48756	182mm	171mm	12mm	32mm
48757	300mm	287mm	12mm	32mm
48758	374mm	362mm	12mm	32mm

✓ 8mm Diameter

Item Code	Overall Length	Centre-to- Centre	Diameter	Projection
48770	120mm	107mm	8mm	33mm
48771	152mm	140mm	8mm	33mm
48772	185mm	173mm	8mm	33mm
48773	232mm	220mm	8mm	33mm
48774	327mm	315mm	8mm	33mm

✓ 8x8mm Square

Item Code	Overall Length	Centre-to- Centre	Diameter	Projection
48759	113mm	106mm	8mm	35mm
48760	146mm	122mm	8mm	35mm
48761	180mm	154mm	8mm	35mm
48762	210mm	182mm	8mm	35mm
48763	245mm	218mm	8mm	35mm
48764	340mm	314mm	8mm	35mm

✓ Brushed Satin Chrome Finish centre bar with polished chrome finish ends (Brass Material)

Item Code	Overall Length	Centre-to- Centre	Diameter	Projection
48794	130mm	110mm	6x20mm	30mm
48795	160mm	140mm	6x20mm	30mm
48796	200mm	180mm	6x20mm	30mm
48797	300mm	280mm	6x20mm	30mm
48798	400mm	380mm	6x20mm	30mm
48799	500mm	480mm	6x20mm	30mm

Item Code	Overall Length	Centre-to- Centre	Diameter	Projection
48800	100mm	80mm	6x15mm	30mm
48801	130mm	110mm	6x15mm	30mm
48802	160mm	140mm	6x15mm	30mm
48803	200mm	180mm	6x15mm	30mm
48804	300mm	280mm	6x15mm	30mm



48517
128mm Kitchen Handle
(below)

Draw Pull Handles

Includes 2 x 40mm M4 screws with snap off points

96mm Centres

8531 - PB
38531 - CP
48531 - SC

128mm Centres

38532 - CP
48532 - SC

96mm Centres

38516 - CP
48516 - SC

128mm Centres

38517 - CP
48517 - SC

96mm Centres

38521 - CP
48521 - SC

128mm Centres

38522 - CP
48522 - SC

96mm Centres

38528 - CP
48528 - SC

128mm Centres

38529 - CP
48529 - SC

96mm Centres

38518 - CP
48518 - SC

128mm Centres

38519 - CP
48519 - SC

96mm Centres

38526 - CP
48526 - SC

128mm Centres

38527 - CP
48527 - SC

96mm Centres

38534 - CP
48534 - SC

128mm Centres

38535 - CP
48535 - SC

96mm Centres

38523 - CP
48523 - SC

96mm Centres

38509 - CP
48509 - SC

96mm Centres

38513 - CP
48513 - SC

Draw Pull Handles



Concealed draw edge pull
overall length(thickness 1.5mm)
48200 - SSSteel 116mm
48201 - SSSteel 166mm
48202 - SSSteel 190mm
48203 - SSSteel 220mm
48204 - SSSteel 320mm



48204 - Satin Stainless Steel 320mm Drawer Edge Pull



64mm Centres

8503 - PB
38503 - CP
48503 - SC



96mm Centres

8504 - PB
38504 - CP
48504 - SC



96mm Centres

8603 - PB



64mm Centres

38505 - CP
48505 - SC

128mm Centres

8604 - PB

96mm Centres

38506 - CP
48506 - SC

128mm Centres

38507 - CP
48507 - SC



50x20mm

38576 - CP
48576 - SC

86x35mm

38577 - CP
48577 - SC



75x18mm

3286 - PB
33286 - CP
43286 - SC



115x28mm

3293 - PB
33293 - CP
43293 - SC



85x35mm

3285 - PB
33285 - CP



96x40mm

5604 - PB
35604 - CP



48517
128mm Kitchen Handle

Draw Pull Handles

✓ Includes 2 x 40mm M4 screws with snap off points



20x20mm	8662 PB / 38862 CP / 48862 SC
25x25mm	8663 PB / 38863 CP / 48863 SC
30x30mm	8664 PB / 38864 CP / 48864 SC



25x25mm	8567 PB / 38867 CP / 48867 SC
30x30mm	8568 PB / 38868 CP / 48868 SC



25x25mm	18677 PVD / 38677 CP / 48677 SC
30x25mm	18678 PVD / 38678 CP / 48678 SC
35x30mm	18679 PVD / 38679 CP / 48679 SC



25x25mm	8659 PB / 38859 CP / 48859 SC
32x32mm	38860 CP / 48860 SC
35x32mm	38553 CP / 48553 SC



28x24mm	38560 CP / 48560 SC
33x27mm	38561 CP / 48561 SC



35x20mm	38563 CP / 48563 SC
47x27mm	38564 CP / 48564 SC



43x20mm	38565 CP / 48565 SC
---------	---------------------



18x25mm	8654 PB / 38654 CP / 48654 SC
21x27mm	8655 PB / 38655 CP / 48655 SC



	Aluminium
15x22mm	48580 SC
20x26mm	48581 SC



25x25mm	18674 PVD / 38674 CP / 48674 SC
30x27mm	18675 PVD / 38675 CP / 48675 SC



30x27mm	8575 PB / 38575 CP / 48575 SC
---------	-------------------------------



25x22mm	18671 PVD / 38671 CP / 48671 SC
30x27mm	18672 PVD / 38672 CP / 48672 SC



40x23mm	38555 CP / 48555 SC
---------	---------------------



20x27mm	8666 PB / 38666 CP / 48666 SC
25x30mm	8667 PB / 38667 CP / 48667 SC



25x30mm	38557 CP / 48557 SC
35x40mm	38558 CP / 48558 SC



32mm	8601 PB / 38601 CP / 48601 SC
------	-------------------------------



22x20mm	8651 PB / 38651 CP / 48651 SC
28x26mm	8652 PB / 38652 CP / 48652 SC



	Aluminium
16x20mm	48584 SC
20x26mm	48585 SC

Flush Bolts

45181 - 75mm
Streamline flush barrel bolt



Streamline Wide Flush Mount "reverse" barrel bolt (Heavy Duty)

12mm straight route rebate for easy installation
bolt is neatly boxed at rear
slide button operation

100mm x 32mm - 45mm bolt throw

5178 - PB
25178 - ATQ
35178 - CP
45178 - SC

150mm x 32mm - 45mm bolt throw

5179 - PB
25179 - ATQ
35179 - CP
45179 - SC



Streamline Slim Flush Mount "reverse" barrel bolt (Heavy Duty)

12mm straight route rebate for easy installation
bolt is neatly boxed at rear
slide button operation

150mm x 19mm - 34mm bolt throw

5180 - PB
35180 - CP
45180 - SC

75mm x 19mm - 34mm bolt throw

5181 - PB
35181 - CP
45181 - SC



Concealed Fixing Heavy Duty Flush Bolt

reinforced guide behind bolt for additional strength

150mm x 19mm - 34mm bolt throw

4444 - PB
24444 - ATQ
34444 - CP
44444 - SC

200mm x 19mm - 34mm bolt throw

4445 - PB
24445 - ATQ
34445 - CP
44445 - SC



Easy Fix Heavy Duty Flush Bolt

reinforced guide behind bolt for additional strength
minimal rebate for installation
push button operation
304 Stainless Steel



150mm x 19mm - 25mm bolt throw

5182 - PB
25182 - ATQ
35182 - CP
45182 - SC

200mm x 19mm - 34mm bolt throw

5183 - PB
25183 - ATQ
35183 - CP
45183 - SC

450mm x 19mm - 34mm bolt throw

5185 - PB
45185 - SC

Heavy Duty Barrel Bolt

100mm x 30mm - 50mm Extended bolt throw
4263 - PB 24263 - ATQ 34263 - CP 44263 - SC

150mm x 30mm - 50mm Extended bolt throw
4264 - PB 24264 - ATQ 34264 - CP 44264 - SC

75mm x 32mm - 25mm bolt throw
4267 - PB 24267 - ATQ 34267 - CP 44267 - SC

100mm x 33mm - 25mm bolt throw
4268 - PB 24268 - ATQ 34268 - CP 44268 - SC

150mm x 33mm - 25mm bolt throw
4269 - PB 24269 - ATQ 34269 - CP 44269 - SC



Heavy Duty Barrel Bolt - Offset

100mm x 30mm - 20mm bolt throw

4271 - PB
24271 - ATQ
34271 - CP
44271 - SC

150mm x 30mm - 20mm bolt throw

4272 - PB
24272 - ATQ
34272 - CP
44272 - SC

General Accessories



cylindrical ferrule keepers
9849 - PB 39849 - CP



flat keeper
please specify particular bolt
9850PB 29850ATQ
39850CP 49850SC



barrel bolt raised keeper
please specify particular bolt
and finish required
#9863



45026 - 300mm
Streamline Panic Dead Bolt

Door/Window Locks

Panic Bolt - Heavy Duty / Offset Bolt

reinforced solid saddle for additional strength
solid brass and heavy duty fixings
concealed fixing

300mm
5046 - PB
35046 - CP
45046 - SC



Panic Bolt - Heavy Duty

reinforced solid saddle for additional strength
solid brass and heavy duty fixings
concealed fixing

255mm
5025 - PB
35025 - CP
45025 - SC

300mm
5026 - PB
35026 - CP
45026 - SC

450mm
5027 - PB
35027 - CP
45027 - SC

600mm
5028 - PB
35028 - CP
45028 - SC



Standard all purpose Flush Bolt

reinforced guide behind bolt for additional strength

150mm x 19mm - 25mm bolt throw
5030 - PB
35030 - CP
45030 - SC

200mm x 19mm - 25mm bolt throw
5031 - PB
35031 - CP



Spring Loaded window or door bolt

Concealed design & upgraded spring mechanism
C4 cylinder key (available keyed alike)
Spring loaded bolt release

40mm x 42mm -31mm projection
39112 - CP
49112 - SC

135mm x 42mm -31mm projection
39111 - CP
49111 - SC

Both bolts Include multiple housing options



Spring Loaded barrel bolt (Heavy Duty)

push button operation



85mm x 42mm -20mm bolt throw
49121 - SC



General Accessories



Angle & Floor keepers
for flush/barrell bolts
4305PB
34305CP
44305SC



Flat Keeper for Panic Bolts
9854 PB
39854 CP
49854 SC



Saddles for Panic bolts
9855PB
39855CP
49855SC



Numbers

316 STAINLESS STEEL NUMBERS
ANYTHING ELSE IS A COMPROMISE!



Shadow Mount Effect
 4892'S' - 150mm - Concealed Fixing Numeral (316 S/Steel)

316 Marine Grade Stainless Steel

Architectural Style

concealed clean "face" with fixing from behind
 flush mountable or raised installation for a "shadow" effect

SATIN STAINLESS STEEL

130mm **150mm**
 4891#0-9 4892#0-9

POLISHED STAINLESS STEEL

130mm **150mm**
 3891#0-9 3892#0-9



304 Commercial Grade Stainless Steel

Architectural Style

concealed clean face with fixing from behind
 flush mountable or raised installation for a "shadow" effect
 55mm

POLISHED STAINLESS STEEL

a **b** **c** **d**
 38100 / 38101 / 38102 / 48103

SATIN STAINLESS STEEL

a **b** **c** **d**
 48100 / 48101 / 48102 / 48103



Contemporary Style

304 Commercial Grade Stainless Steel

25mm(PB) **50mm** **75mm** **100mm** **150mm**
 18810#0-9 18820#0-9 18830#0-9 18840#0-9 18850#0-9

POLISHED STAINLESS STEEL

50mm **75mm** **100mm** **150mm**
 38820#0-9 38830#0-9 38840#0-9 38850#0-9



Classic Style

304 Commercial Grade Stainless Steel

75mm **100mm**
 18870#0-9 18880#0-9

POLISHED STAINLESS STEEL

75mm **100mm**
 38870#0-9 38880#0-9



Door Stop & Catch



Door/Skirting Mounted Door Catch
 Heavy Duty Catch
 Base: 65mm projection / Catch projection 55mm
 3320 - PB
 33320 - CP
 43320 - SC



Door/Skirting Mounted Door Catch
 Heavy Duty Catch
 Base: 32x25mm / Catch projection 32mm
 3321 - PB
 33321 - CP
 43321 - SC



Door/Skirting Mounted Door Catch
 Heavy Duty Catch
 Base: 65mm projection / Catch projection 38mm
 3322 - PB
 33322 - CP
 43322 - SC

Door Stops

304 Stainless Steel

Wall Mounted 304 Stainless Steel

includes expansion bolt & wood screw fixings
L:85mm Diam: 17mm
13711 - PVD Brass
33711 - PSS
43711 - SSS

43711 - 85mm
Square Design Wall Mounted
Solid Stainless Steel Door Stop



Wall Mounted 304 Stainless Steel

includes expansion bolt & wood screw fixings
L:85mm Diam: 25x25mm
13711 - PVD Brass
33711 - PSS
43711 - SSS

Floor Mounted 304 Stainless Steel

includes expansion bolt & wood screw fixings
L:40mm Diam: 25mm
13715 - PVD Brass
33715 - PSS
43715 - SSS



Floor Mounted 304 Stainless Steel

includes expansion bolt & wood screw fixings
L:45mm Diam: 25x25mm
13710 - PVD Brass
33710 - PSS
43710 - SSS

Floor Mounted 304 Stainless Steel

includes expansion bolt & wood screw fixings
L:40mm Diam: 30mm
13714 - PVD Brass
33714 - PSS
43714 - SSS



Floor Mounted 304 Stainless Steel

includes expansion bolt & wood screw fixings
L:40mm Diam: 35mm
13712 - PVD Brass
33712 - PSS
43712 - SSS

Floor Mounted 304 Stainless Steel

includes wood screw fixings
L:40mm Diam: 30mm
13714 - PVD Brass
33714 - PSS
43714 - SSS

Material: Brass
[3080PB / 33080CP / 43080SC]

Risen Base for elevated height

45mm diameter - 12mm raised base
4302PB / 34302CP / 44302SC



Floor Mounted 304 Stainless Steel

includes expansion bolt & wood screw fixings
L:50mm Diam: 25mm
13713 - PVD Brass
33713 - PSS
43713 - SSS

Floor Mounted Square Design

Material: Brass
includes wood screw fixings
L:40mm
33718 - CP
43718 - SC



Floor Mounted Tri-design

Material: Zinc
wood screw fixings
Diam: 45mm
33728 - PC
43728 - SC

Floor Mounted Magnetic Catch Risen Base for elevated catching height

L/W: 45x38mm
13723 - PVD Brass
33723 - CP
43723 - SC



Floor Mounted Magnetic Catch

L/W 53x34mm
3722 - PB
33722 - CP
43722 - SC

Floor or Wall Mounted Square Design

includes wood screw fixings
H:75mm Base: 48x48mm
33729 - CP
43729 - SC



Floor Mounted Magnetic Catch

L/W 45x37mm
(below) 43727 - SC



Foot Operated Door Catch

Door Closer



Floor Mounted Tri-design

H/W: 185x30mm
34099 - PC
44099 - SC



Door Closer
Spring Loaded
Modern Concealed Fix
115x30mm # 43730 - SC



quick reference appendix...

opening doors in au**STYLE**

The austyle philosophy demonstrates how good ideas become reality.

Every austyle product is designed and manufactured with an emphasis on quality raw materials, practical functionality and unique designs.

Whether the product is 304 stainless steel or solid virgin brass, strength in foundation through the use of high grade raw materials ensures austyle products can withstand the tolerances required in all commercial or domestic, internal or external applications.

austyle products are manufactured to exceed ISO9000 international quality standards and are mechanically and practically functional as well as simple and easy to install.

Our in house design team develops products that reflect current market styles and trends and many of our unique designs have design registrations and mechanical patents to protect their individuality.

Welcome to the austyle range of quality architectural hardware and a new approach in design innovation.

For your nearest distributor:

t 03 9553 3559

f 03 9553 3558

e info@austyle.com.au

www.austyle.com.au



au**STYLE** architectural hardware